

LA PERCEE VERTE

SOCIETE DE PROMOTION
IMMOBILIERE: JOUMAIRA
IMMOBILIERE

CONSTRUCTION D'UN
IMMEUBLE DE BUREAUX
AUX JARDINS DE
CARTHAGE

BLOC A
TYPE BUREAUTIQUE
6 EME ETAGE
SURFACE HORS
OEUVRE : 187 m²
SURFACE
VENDABLE: 258.85m²

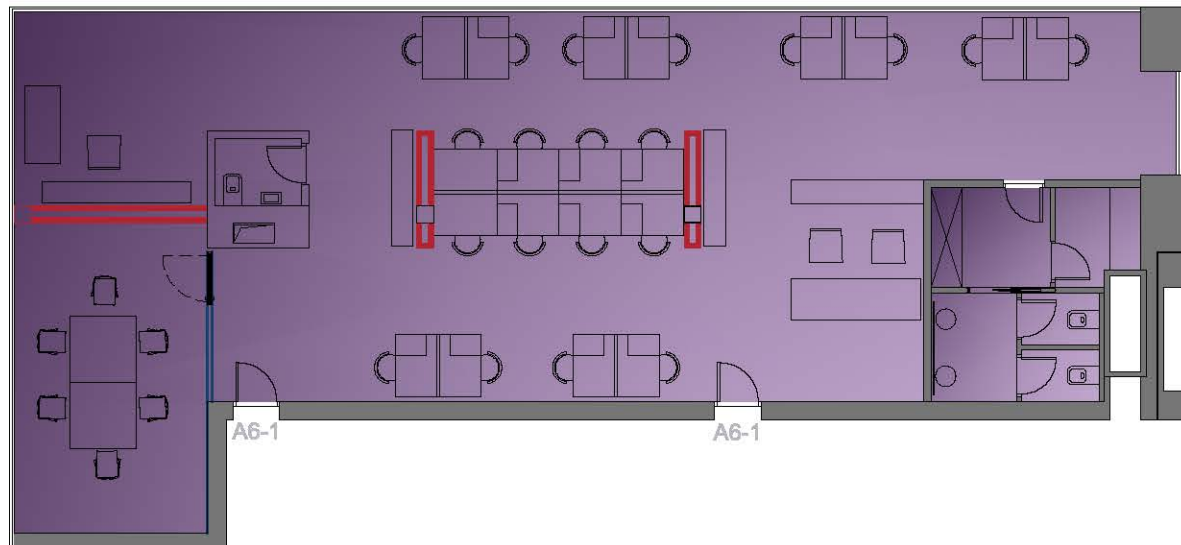

ACQUEREUR

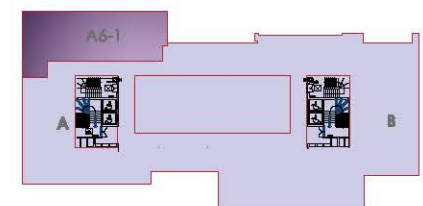

SITUATION